

Using the Square Break tool to add roof extensions

Posted by: host 10/31/2006
4:52:00 PM

Have you ever seen an estimate tree in Xactimate where the roof section is listed as Roof1, Roof2, Roof3 and so on? Well in most cases this occurs when the estimate writer uses the "roof icon" or the "f" key to add the extensions to the main roof diagram in Sketch, when a better option would be to use the "Square Break" tool to add extensions to the roof.

Have you ever seen a tree in an Xactimate® estimate that listed the Roof as Roof1, Roof2 and so on and only be dealing with one building? If so then the tree in Xactimate may have looked like the one below. I have and in this blog I'm going to show you how to eliminate the multiple entries. I will not get into editing the name or dimensions in this blog but will in a later blog. I often have to review files and a tree like this to me makes it harder to get an understanding of what the adjuster is doing.

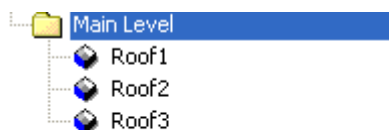

In most cases this is because the estimate writer is using the Roof icon or the "f" key to add a roof extension. I'm going to create a simple gable roof and show the



adding of two extensions using the Roof icon.

The images below show the steps used when adding an extension in this matter and the results.

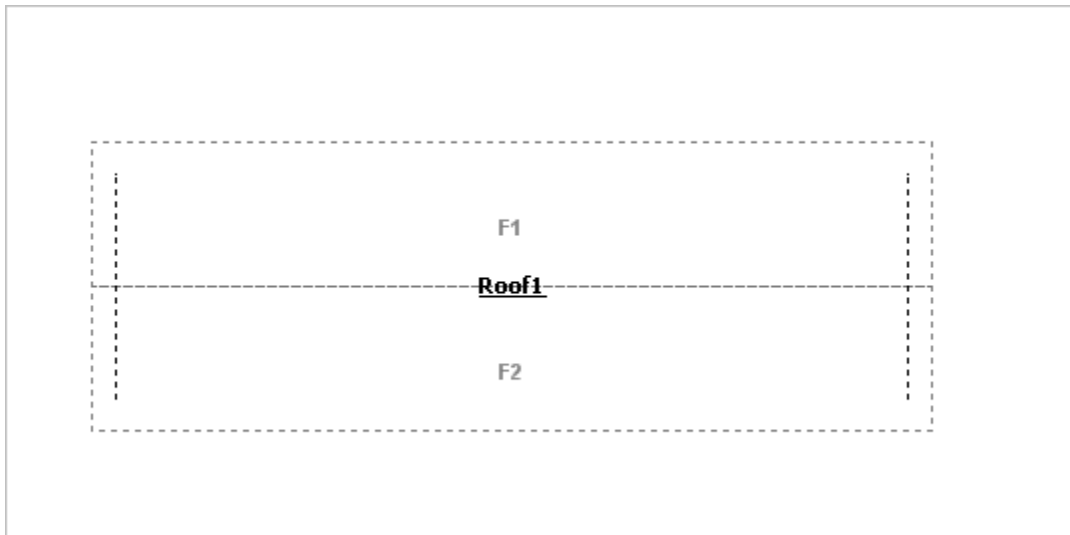

First we start with a simple roof using the roof icon or f key. Then when we want to add an extension we incorrectly use the roof icon again.

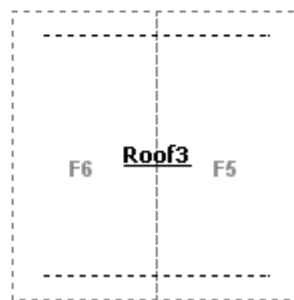
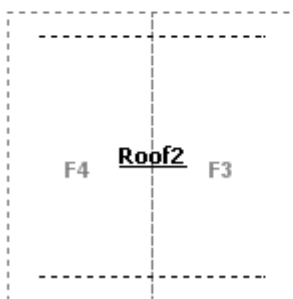
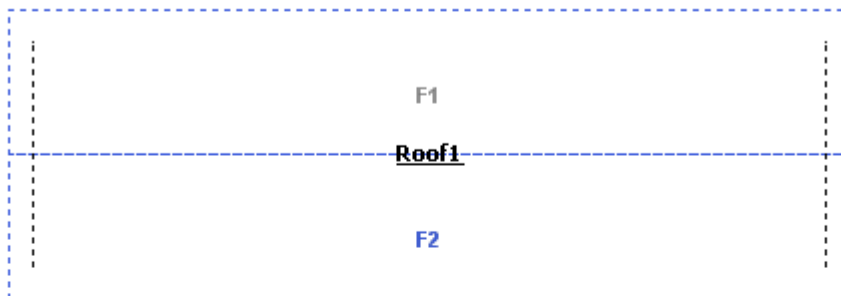

And combine the two extensions by dragging them to the area we want them to appear.

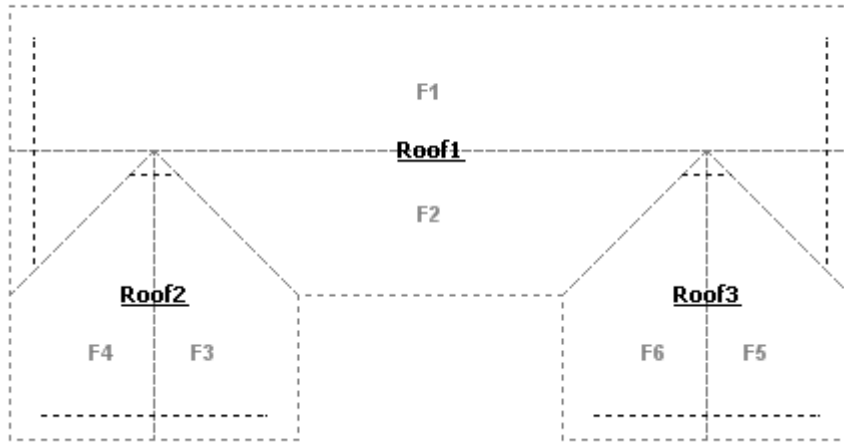

Once the extensions have been added to the diagram above your tree will look like this.

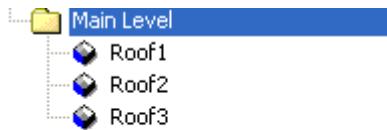

In the example below we use the "Square Break" icon or the "B" key.

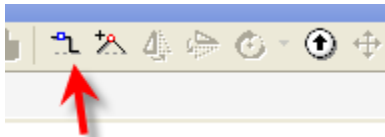

Once we have the "Square Break" tool active we go to diagram and select the area for the extension.

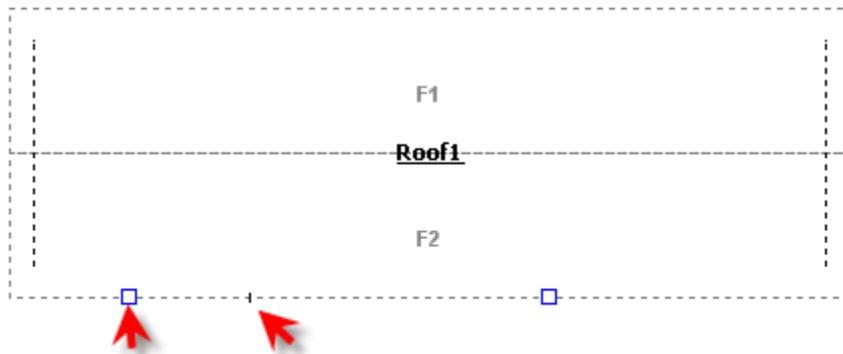

We use the "Ctrl" key and drag this blue square out to create the extension.

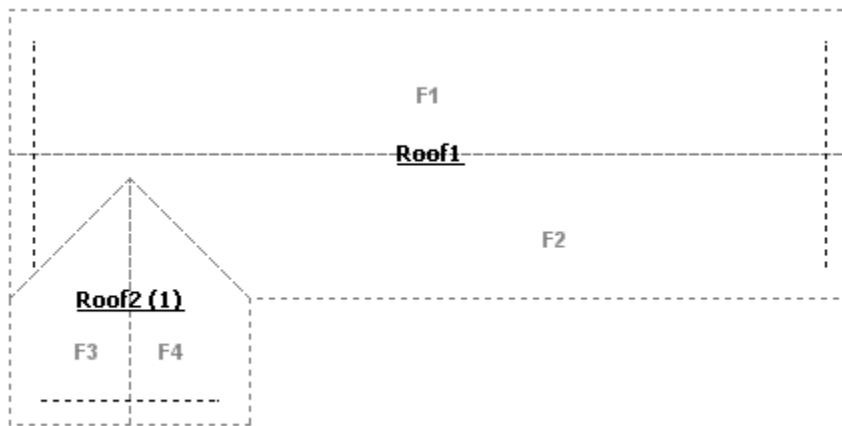

We repeat the process for the second extension.

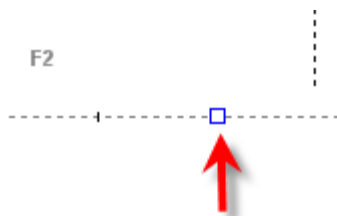

Hold the "Ctrl" key down while with your mouse you grab (left click) and drag the box out to form the extension and end up with a roof diagram as shown below.

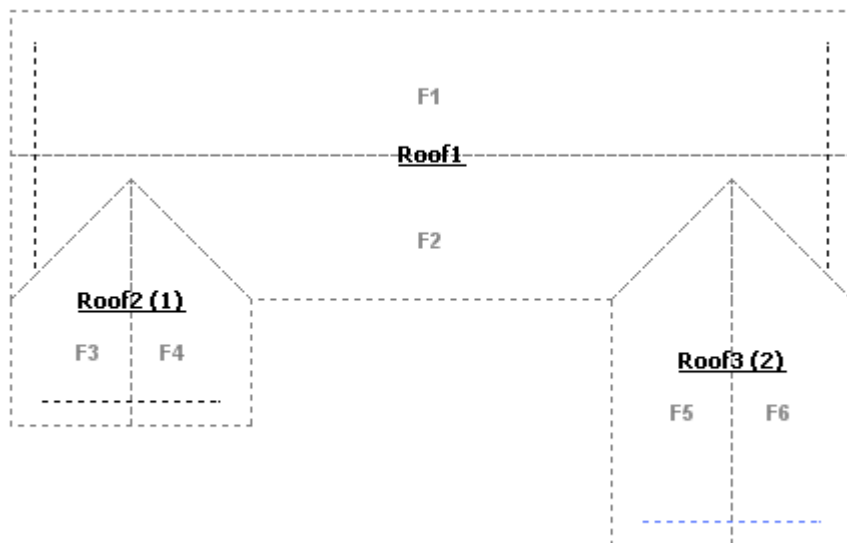

Now take a look at our tree.



You can now add your line items to the estimate under one entry, of course Roof1 does not provide much information you could also change the name to just Roof and the group header (Main Level) to Dwelling to indicate Dwelling Roof. We will review changing names and tweaking the diagram in another blog. I have included the above roof sketch template below that you can download and load into your sketch. This tip was made using Xactimate® version 24.10.

Thanks for visiting.

[Sketch Template Unzip to use](#)